

Style BA

Y-Strainer

Cast Bronze (ASTM B 62)

150 lb. & 300 lb. Flanged



Cast Bronze Y-Strainer

APPLICATIONS

Steam, water, oil or gas where protection from foreign matter in a pipeline is required.

CONSTRUCTION

The Keckley Style BA strainers are constructed from the finest bronze castings and are machined to exacting specifications. These bodies have drilled flanges that are in accordance with ASME B16.24.

FEATURES

The Keckley Style BA strainer features a machined groove in both the body and cover for proper screen alignment and to ensure accurate reseating when servicing is required. The gasket is a flexible laminated sheet that is compressed between the body and cover for maximum strength and durability. All Keckley Style BA strainers can be furnished with a brass blow-off plug upon request.

SCREENS

Standard perforated brass screens are spot welded along the seam for maximum strength. Different size perforations and meshes are available in brass, stainless steel, and monel to meet specific media requirements. If the media is not indicated, screens for *water* will be supplied.

SELF CLEANING

Self cleaning is accomplished by opening the valve or drain plug connected to the blow-off port. **Warning:** See Maintenance Instructions on page S6 of the Strainer Information Section for additional precautions and detailed information on servicing the strainer.

WORKING PRESSURES – NON SHOCK

NOM. RATING	MEDIA	2" to 6"	50 mm to 150 mm
150# F.F. & D. (STANDARD FLANGE)	STEAM	150 PSI @ 406°F	1035 KPa @ 208°C
	W.O.G.	225 PSI @ 150°F	1552 KPa @ 66°C
NOM. RATING	MEDIA	2" to 6"	50 mm to 150 mm
300# F.F. & D. (EX. HEAVY FLANGE)	STEAM	300 PSI @ 406°F	2069 KPa @ 208°C
	W.O.G.	500 PSI @ 150°F	3449 KPa @ 66°C

Style BA

Y-Strainer, 150 lb. & 300 lb. Flanged
Cast Bronze (ASTM B 62)

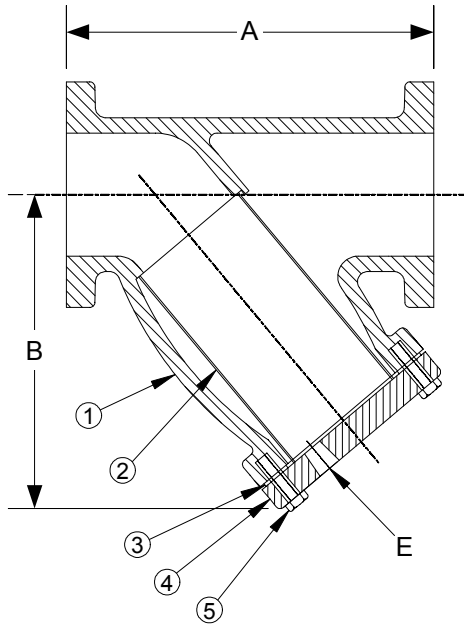
PARTS LIST

ITEM	DESCRIPTION	MATERIAL
1	BODY	CAST BRONZE (ASTM B 62)
2	SCREEN	BRASS
3	GASKET	COMPOSITION
4	COVER	CAST BRONZE (ASTM B 62)
5	HEX HEAD CAP SCREWS	STEEL

Optional: Blow-off Plug, Brass

STANDARD SCREENS SUPPLIED

SIZE		SCREEN GAGE	SCREEN PERFORATION					
in	mm		FOR STEAM		OPEN AREA	FOR LIQUID		OPEN AREA
			in	mm		in	mm	
2 to 4	50 to 100	28	3/64	1.2	33%	1/16	1.6	30%
5 to 6	125 to 150	24	3/64	1.2	33%	1/8	3.2	43%

Standard screens supplied are for **liquid service**, unless otherwise specified.
 Options: Other perforations, meshes, and screen materials are available.

SIZE		DIMENSIONS								WEIGHTS			
		A				B		E		150#		300#	
		150#		300#		150# & 300#		150# & 300#		lbs	kgs	lbs	kgs
in	mm	in	mm	in	mm	in	mm	in	mm				
2	50	8-1/8	206	8-5/8	219	8-1/4	210	1-1/4	32	34	15	39	18
2-1/2	65	9-5/8	244	10-1/8	257	8-1/2	216	1-1/4	32	40	18	57	26
3	80	10-3/8	264	10-15/16	278	8-1/2	216	1-1/4	32	51	23	74	34
4	100	14-7/8	378	15-1/4	387	12-1/2	318	2	50	109	49	149	68
5	125	16	406	16-3/4	425	14-1/2	368	2	50	161	73	221	100
6	150	18-9/16	471	18-1/8	460	14	381	2	50	195	88	253	115

Larger sizes available upon request.

Certified dimensional drawings are available upon request.

†This table reflects only the nearest metric equivalents.

PRESSURE vs. TEMPERATURE CHART

150# & 300# Flanged Cast Bronze (ASTM B 62)

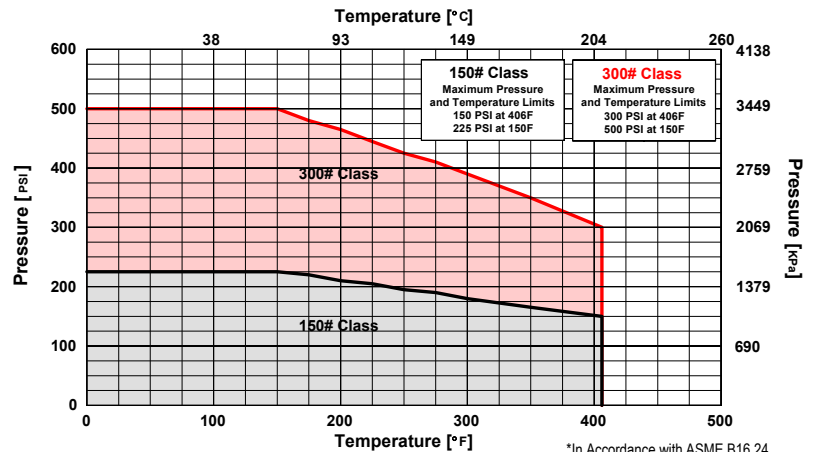
FLOW COEFFICIENTS

Size	C _v	Size	C _v
2"	62	4"	269
2-1/2"	98	5"	364
3"	155	6"	585

TOTAL SCREEN AREA

Size	(in ²)	Size	(in ²)
2"	51.55	4"	154.98
2-1/2"	70.01	5"	219.79
3"	85.86	6"	245.08

*See DETERMINING RATIOS on page S5 of the Strainer Information Section for calculating NET FREE AREA of the screen to inside pipe area.

*In Accordance with ASME B16.24