

Style BDI

Y-Strainer

Ductile Iron (ASTM A 536, Grade 65-14-12)
300 lb. Threaded



Ductile Iron Y-Strainer

APPLICATIONS

Steam, water, oil or gas where protection from foreign matter in a pipeline is required.

CONSTRUCTION

The Keckley Style BDI strainers are constructed from rugged ductile iron castings that are machined to exacting specifications.

FEATURES

The Keckley Style BDI strainer features a tapered bushing and is furnished standard with a NPT blow-off connection and can be supplied with a iron blow-off plug upon request.

SCREENS

Standard screens are 20 mesh 304 stainless steel and are spot welded for maximum strength. Different size perforations and meshes are available in stainless steel, monel, and brass to meet specific media requirements. If media is not indicated, screens for *water* will be supplied.

SELF CLEANING

Self cleaning is accomplished by opening the valve or drain plug connected to the blow-off port. **Warning:** See Maintenance Instructions on page S6 of the Strainer Information Section for additional precautions and details on servicing the strainer.

WORKING PRESSURES – NON SHOCK

NOM. RATING	MEDIA	1/2" to 2"	15 mm to 50 mm
300# (THREADED)	STEAM	450 PSI @ 650°F	3104 KPa @ 343°C
	W.O.G.	640 PSI @ 100°F	4414 KPa @ 38°C

Style BDI

Y-Strainer, 300 lb. Threaded
Ductile Iron (ASTM A 536, Grade 65-14-12)

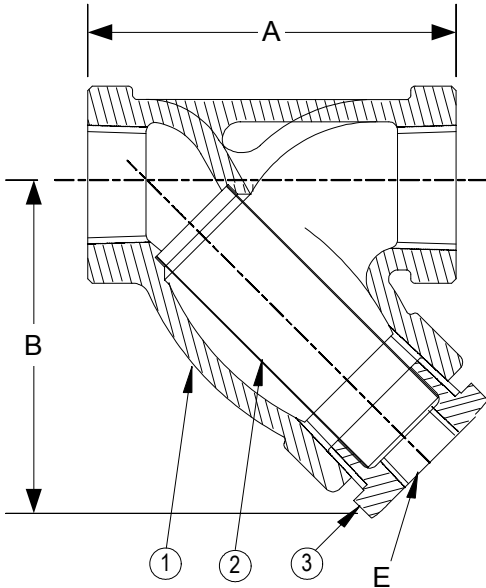

PARTS LIST		
ITEM	DESCRIPTION	MATERIAL
1	BODY	DUCTILE IRON* (ASTM A 536, GRADE 65-14-12)
2	SCREEN	STAINLESS STEEL (304)
3	BUSHING	DUCTILE IRON

Optional: Blow-off Plug, Malleable Iron

STANDARD SCREENS SUPPLIED

SIZE		SCREEN GAGE	SCREEN PERFORATION				
			FOR STEAM		OPEN AREA	FOR LIQUID	
in	mm		in	mm	in	mm	OPEN AREA
1/2 to 2	15 to 50		20 MESH STAINLESS STEEL				49%

Options: other meshes, perforations and screen materials are available.

SIZE		DIMENSIONS						WEIGHTS	
		A		B		E			
in	mm	in	mm	in	mm	in	mm	lbs	Kgs
1/2	15	3	76	2-5/8	67	3/8	10	2	0.9
3/4	20	4	102	3-5/8	92	1/2	15	3	1.4
1	25	4-7/8	124	4-1/2	114	3/4	20	4.5	2.0
1-1/4	32	5-1/8	130	4-3/4	121	3/4	20	5	2.3
1-1/2	40	5-3/4	146	4-7/8	124	1	25	8	3.6
2	50	7-1/4	184	5-3/4	146	1-1/4	32	15	6.8

†This table reflects only the nearest metric equivalents.

FLOW COEFFICIENTS

Size	C _v	Size	C _v	Size	C _v
1/2"	9.5	1"	30	1-1/2"	61
3/4"	18.7	1-1/4"	44.9	2"	98

TOTAL SCREEN AREA

Size	(in ²)	Size	(in ²)	Size	(in ²)
1/2"	5.50	1"	15.22	1-1/2"	23.37
3/4"	8.59	1-1/4"	18.69	2"	36.23

*See DETERMINING RATIOS on page S5 of the Strainer Information Section for calculating NET FREE AREA of the screen to inside pipe area.

* Tensile Strength: 60/80,000 PSI
Yield Strength: 45/60,000 PSI
Elongation: 10/30%

Certified Dimensional Drawings are Available Upon Request.