

Style SSB

Y-Strainer

Stainless Steel (ASTM A 351, Grade CF8M)

1500 lb. Threaded

1500 lb. Socket Weld



Cast 316 Stainless Steel Y-Strainer

APPLICATIONS

Steam, water, oil or gas where protection from foreign matter in a pipeline is required.

CONSTRUCTION

The Keckley Style SSB strainers are constructed from rugged 316 stainless steel castings and are machined to exacting specifications.

Socket Weld bore is in compliance with ASME B16.11 unless otherwise specified.

FEATURES

The Keckley Style SSB strainer features a machined groove in both the body and cap for proper alignment and to ensure accurate reseating when servicing is required. This strainer has a bolted cover and is furnished standard with an optional NPT blow-off connection. The gasket is 304 stainless steel spiral wound and is compressed between the body and cover (for maximum strength and durability) and designed for high pressure and high temperature service. The cover is not supplied with a blow-off hole.

SCREENS

Standard perforated 304 stainless steel screens are spot welded along the seam for maximum strength. Different size perforations and meshes are available in stainless steel, monel, and brass to meet specific media requirements. If media is not indicated, screens for *steam* will be supplied.

CLEANING THE STRAINER SCREEN

Warning: See Maintenance Instructions on page S6 of the Strainer Information Section for additional precautions and detailed information on servicing the strainer.

WORKING PRESSURES – NON SHOCK

NOM. RATING	MEDIA	1/2" to 3"	15 mm to 80 mm
1500# (THREADED & SOCKET WELD)	STEAM	1500 PSI @ 1125°F	10346 KPa @ 607°C
	W.O.G.	3600 PSI @ 100°F	24829 KPa @ 38°C

Style SSB

Y-Type, 1500 lb. Threaded & Socket Weld
 Cast 316 Stainless Steel (ASTM A 351, Grade CF8M)

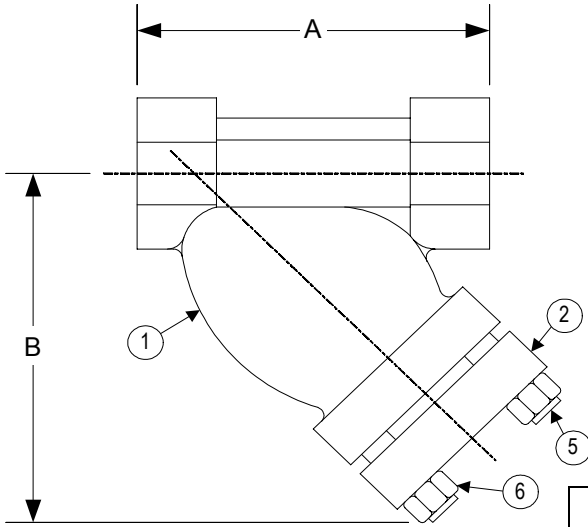
PARTS LIST

ITEM	DESCRIPTION	MATERIAL
1	BODY	CAST STAINLESS STEEL (ASTM A 351, GRADE CF8M)
2	COVER	CAST STAINLESS STEEL (ASTM A 351, GRADE CF8M)
3	SCREEN (NOT SHOWN)	STAINLESS STEEL (304)
4	GASKET (NOT SHOWN)	SPIRAL WOUND STAINLESS STEEL (304)
5	STUDS	STAINLESS STEEL (316) ASTM A 193 – B8
6	NUTS	STAINLESS STEEL (316) ASTM A 194 GRADE 8

STANDARD SCREENS SUPPLIED

SIZE		SCREEN GAGE	SCREEN PERFORATION					
in	mm		FOR STEAM		OPEN AREA	FOR LIQUID		OPEN AREA
			in	mm		in	mm	
1/2 to 3	15 to 80	26	1/32	.8	28%	1/16	1.6	37%

Standard screens supplied are for **steam service**, unless otherwise specified.
 Options: Other perforations, meshes, and screen materials are available.

SIZE		DIMENSIONS				WEIGHTS	
		A		B			
in	mm	in	mm	in	mm	lbs	kgs
1/2	15	3-15/16	100	3	76	10	5
3/4	20	4-1/4	108	3-3/4	95	12	5
1	25	5	127	5	127	15	7
1-1/4	32	8-3/8	213	5-1/2	140	22	10
1-1/2	40	8-3/8	213	5-1/2	140	22	10
2	50	9-5/16	237	7-3/8	187	30	14
2-1/2	65	12	305	10-1/2	267	50	23
3	80	12	305	10-1/2	267	50	23

Certified dimensional drawings are available upon request.
 †This table reflects only the nearest metric equivalents.

PRESSURE vs. TEMPERATURE CHART

1500# Threaded & Socket Weld Cast 316 Stainless Steel (ASTM A 351, Class CF8M)

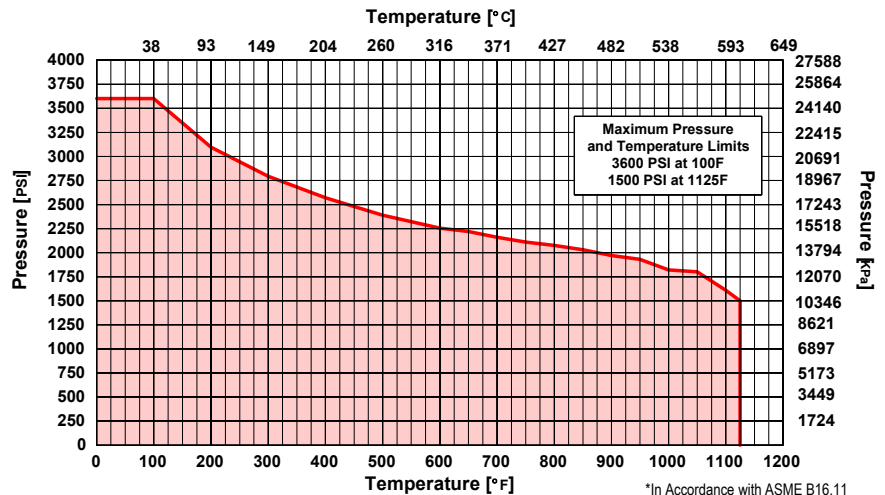

*In Accordance with ASME B16.11

FLOW COEFFICIENTS

Size	C _v	Size	C _v	Size	C _v
1/2"	9	1-1/4"	45	2-1/2"	129
3/4"	18	1-1/2"	60	3"	170
1"	30	2"	98		